



Symbol for Perfection

## Flail choppers • series BK2



Because of their low and compact but heavy construction our Flail Choppers Series BK2 are very popular for chopping orchard- and vineyard prunings up to 10 cm (4") diameter.



They are fitted with a parallelogram-type offset feature as standard.

Their profile is very low: the height of the V-belt cover is only 51 cm (20"), even for the front mounted models.

The flail rotor bearings are mounted inside the frame, which means that the ratio of cutting width to overall width is maximised.



A full width rear roller with conical ends and skids at both sides provides excellent stability and easy handling. To protect the bearings of the rear rollers, the bearings are fitted with unique covers to prevent humidity, dust and mud from entering.



A gearbox with spiral toothed gears and the V-belts with a springloaded automatic belt tensioner assure an indirect flexible drive with maximum security and a minimum maintenance.

# FLAIL CHOPPERS SERIES BK2

For a better pick-up and pulverization of thin prunings or prunings that are laying flat, our flail choppers Series BK2 are delivered with rake tines which are adjustable in height.

Available options:

- "Perfect" pulling type headstock for front mount
- Ram for hydraulic offset adjustment
- Wearing plate
- Plate for improved pulverization of leaves

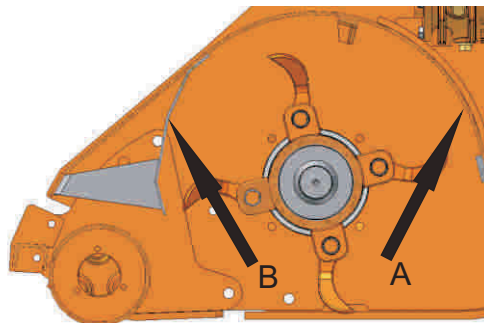

Wearing plate

For extreme conditions an extra wearing plate (A) is available which will be welded to the inside of the frame.

Improved leave chopping

To counter the increasing scrap problems an optional plate is available which can be bolted to the inside of the flail chopper (B) when chopping leaves. As a result of this the material is even further minimized before it can leave the machine.

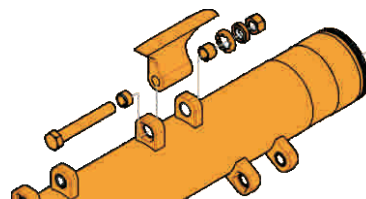

Flail 2,2 kg = 5 lb

Front mount (option)

A front mounted flail chopper can more easily deal with larger quantities of prunings because the tractor has not run over the prunings before chopping them.

The unique cantilever design of the headstock enables the front mounted version of the "Perfect" flail chopper to be pulled rather than pushed. This protects the machine and provides a full floatation effect.

By reversing the headstock our front mount models can also be used as rear mounted machines. Available for either 540 rpm or 1000 rpm of pto.

The 2,2 kg (5 lbs) heavy-duty "Perfect" flails are especially designed for pulverizing prunings. They are fitted to the electronically balanced vibration-free flail rotor with heavy bolts and replaceable steel bushings and provide an excellent pulverization. No further work is necessary to collect or remove the cut material. Optional flails of 0,8 kg (1 3/4 lbs) are available for grass cutting and light chopping work (vineyard prunings, leaves etc.).

BK2 – with rake tines	BK2-090	BK2-105	BK2-120	BK2-150
Cutting width cm/inch	90/2'9"	105/3'5"	120/3'11"	150/4'11"
PTO speed rpm	540	540	540	540
Flail rotor speed rpm	2100	2100	2100	2100
Minimum power 540 rpm				
• grass cutting etc. kW/HP		18/25	18/25	22/30
• brush chopping etc. kW/HP	22/30	22/30	26/35	30/40
Flails 2,2 kg = 5 lbs std.	6	6	8	9
Flails 0,8 kg = 1 3/4 lbs option	12	12	12	16
Total width cm/inch	110/3'6"	125/4'1"	142/4'8"	170/5'7"
Tractor 3-pt. linkage cat	I + II	I + II	I + II	I + II
Maximum offset from centre of tractor cm/inch		65/2'2"	80/2'7"	110/3'7"
Weight BK2 kg/lbs	385/849	515/1135	545/1211	600/1333
Number of rake tines (BK2)	8	8	9	11

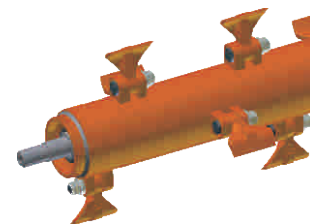

Flail 0,8 kg = 1 3/4 lb



Distributed by:



Technical specifications can be changed without prior notice